

Townsend Bearings

**DRIVES,
CONTROLLERS
&
COUPLINGS
CATALOGUE**

COUPLINGS & UNIVERSAL JOINTS

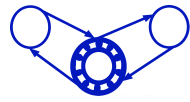



Townsend Bearings

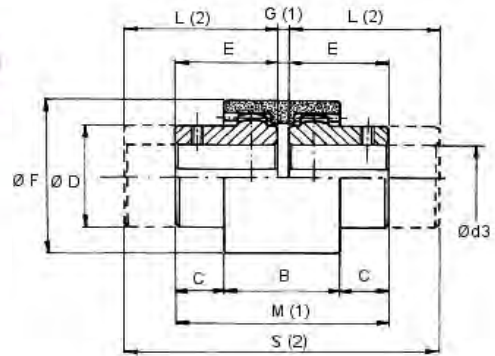

Nylon Sleeve Gear Couplings Industry Standard

Coupling Type	Nominal Bore ⁽³⁾	Max. Bore	Standard Hubs								Long Hubs		Number of Teeth	Tooth O/D mm	Tooth Length mm
			B	C	Ø D	E	Ø F	G ⁽¹⁾	M ⁽¹⁾	L ⁽²⁾	S ⁽²⁾				
GF14	6	14	38	6.5	25	23.5	41	4	51	30	64	21	33.8	8	
GF19	8	19	38	8.5	32	25.5	48	4	55	40	84	26	41.3	8	
GF24	10	24	42	7.5	36	26.5	52	4	57	50	104	28	44.5	8	
GF28	10	28	48	19	45	41	68	4	86	60	124	35	54.5	10	
GF32	12	32	48	18	50	40	75	4	84	60	124	38	58.8	10	
GF38	14	38	50	17	58	40	85	4	84	80	164	44	67.6	12	
GF42	20	42	50	19	63	42	95	4	88	110	224	47	71.6	12	
GF48	20	48	50	27	68	50	100	4	104	110	224	50	76	12	
GF55	25	55	65	29.5	82	60	120	4	124	110	224	46	94.7	15	
GF65	25	65	72	36	95	70	140	4	144	140	284	56	115	18	

All dimensions in mm unless specified

(1) Assembled length.

(2) Coupling hub length to fully fit standard shafts of UNEL-MEC range of motors.

(3) Finished bores to H7 tolerance and keyways on request.

If a dimension is critical to your application please contact our sales department for confirmation.

Please note : errors and omissions excepted.